

VTC SERIES

316 STAINLESS STEEL BSP, CLASS 200 PSI
SWING CHECK VALVE

FEATURES

Size Range:	DN8 - DN80 (1/4" - 3")
Pressure Rating:	200 PSI W.O.G at 20°C
Connection:	BSP
Features:	<ul style="list-style-type: none"> Investment casting body Stainless Steel Full Port Screwed Cap Integral Seat



MATERIAL SPECIFICATIONS & PARTS LIST

NO.	DESCRIPTION	MATERIAL
1	Body	CF8M
2	Cap	CF8M
3	Gasket	PTFE
4	Plug	SUS316
5	Disc	CF8M
6	Gasket	PTFE
7	Bolt	SUS304

DIMENSIONAL DRAWINGS

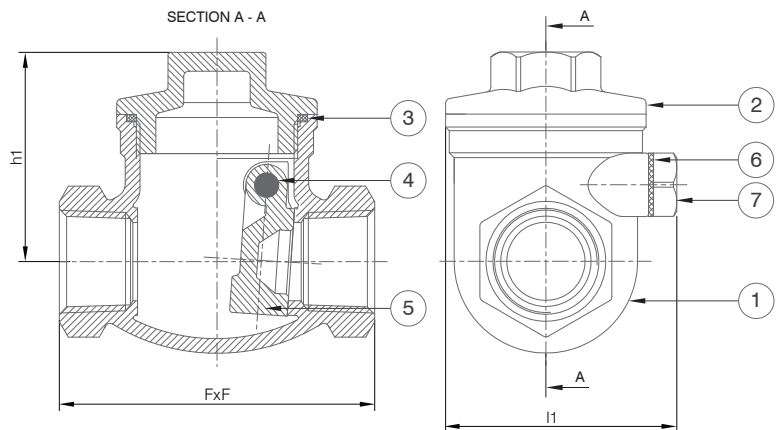

DIMENSIONS (MM)

DN	NPS	FxF	h	l	Weight (Kg)
8	1/4"	65	43	46.5	0.36
10	3/8"	65	43	46.5	0.36
15	1/2"	65	43	46.5	0.36
20	3/4"	80	51	51.5	0.43
25	1"	89	60	56	0.66
32	1 1/4"	105	66	64	0.93
40	1 1/2"	120	75	74.5	1.49
50	2"	139	80	84.4	2.15
65	2 1/2"	181	99	105	5.27
80	3"	200	104	136	7.70

PRESSURE RATING

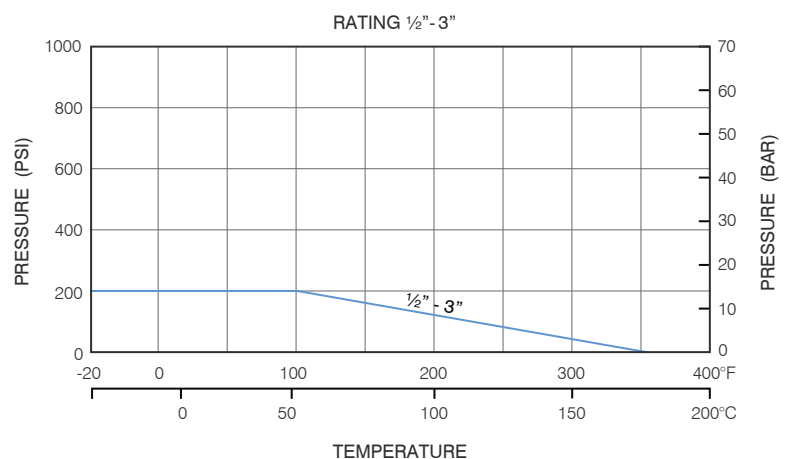

FACTORY ACCREDITED:



Designs, materials and specifications shown are subject to change without notice due to our continuing program of product development. VTC_V1a_20150929.

All content is protected by Copyright and is owned and/or licensed by AVFI Pty Ltd. Copyright © AVFI Pty Ltd.