

# V2FH-316-150 SERIES

CLASS 150, 2 PIECE DIRECT MOUNT  
316 STAINLESS STEEL FLANGED BALL VALVE  
DN65 - DN150

## TECHNICAL DATA

Size Range:	DN65 - DN150 (2 1/2" - 6")
Pressure Rating:	ANSI-150
Pressure Test:	AP1598
Flange Connection:	
65mm to 100mm	<ul style="list-style-type: none"> <li>AS4087 CL16</li> <li>AS2129 T/E</li> <li>ANSI-150</li> </ul>
125mm & 150mm	<ul style="list-style-type: none"> <li>ANSI-150 (standard)</li> <li>AS4087 CL16 (optional)</li> <li>AS2129 T/E (optional)</li> </ul>
Features:	<ul style="list-style-type: none"> <li>SS316 body, cap &amp; ball.</li> <li>Full bore.</li> <li>Solid ball.</li> <li>Internal entry blow-out proof stem.</li> <li>Lever operated.</li> <li>Direct mounting pad ISO 5211.</li> <li>Anti-static device, fire-safe design.</li> <li>Flange pattern as required.</li> <li>Fire-safe approved on request.</li> <li>VEE port available on request.</li> </ul>

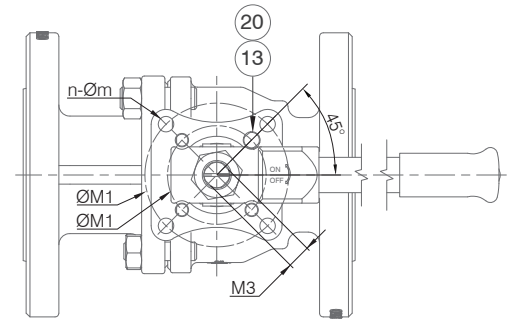
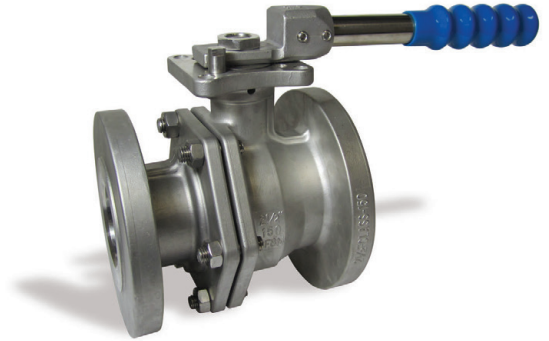

## MATERIAL SPECIFICATIONS & PARTS LIST

NO.	DESCRIPTION	MATERIAL	NO.	DESCRIPTION	MATERIAL
1	Body	CF8M	12	Stem Nut	SS304
2	End Cap	CF8M	13	Stopper	SS304
3	Ball	CF8M	14	Bar Handle	SS304
4	Seat	PTFE	15	Plastic Sleeve	Plastic
5	Joint Gasket	PTFE	16	Nut	SS304
6	Stem	SS316	17	Stud Bolt	SS304
7	Thrust Washer	PTFE	18	Nut	SS304
8	O-Ring	Viton	19	Stud Bolt	SS304
9	Stem Packing	PTFE	20	Stopper Pin	SS304
10	Stem Ring	SS304	21	Lock Washer	SS304
11	Belleville Washer	SS304			

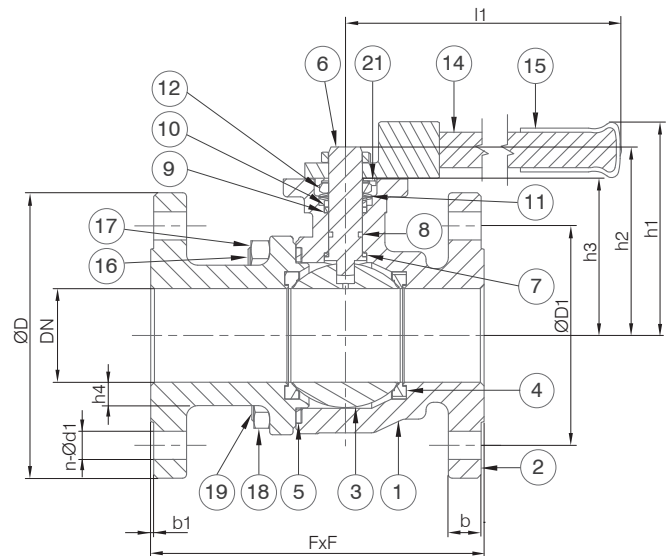

## DIMENSIONS (MM)

V2FH-316-150 DN65 - DN150																
DN	NPS	FxF	b	b1	ØD	ØD1	n-Ød1	h1	h2	h3	l1	ØM1	n-Øm	M3	Torque (N.m)	Weight (Kg)
65	2 1/2"	190	20.8	1.6	178	139.5	4-19	156	137	119	278	70/102	4-9/11	17	37	15.9
80	3"	203	22.3	1.6	191	152.5	4-19	167	148	130	278	70/102	4-9/11	17	61	20.3
100	4"	230	22.3	1.6	229	190.5	8-19	182	164	145	378	70/102	4-9/11	17	96	30
125	5"	325	22.3	1.6	255	215.9	8-22.5	225	202	159	415	102/125	4-12/14	27	157	48.4
150	6"	350	23.9	1.6	280	241.3	8-22.5	240	221	175	415	102/125	4-12/14	27	206	64.2

## PRESSURE RATINGS

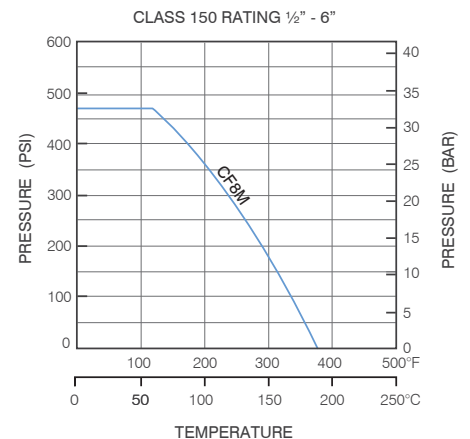

FACTORY ACCREDITED:



FIRE SAFETY  
APPROVAL AP1607



6D-0645



No. WZ 1093  
HH 1



NUMBER  
0035

Designs, materials and specifications shown are subject to change without notice due to our continuing program of product development. V2FH-316-150\_DN65-DN150\_V1\_20130618.

All content is protected by Copyright and is owned and/or licensed by AVFI Pty Ltd. Copyright © AVFI Pty Ltd.

AVFI Pty Ltd: 54 Enterprise Drive, Bundoora, Victoria, Australia 3083  
T: 03 8467 0000 F: 03 8467 0099 E: avfi@avfi.com.au www.avfi.com.au