

Model XDV-11



XDV *Knife Gate Valves*

Features

- Bi-Directional
- 100% Water Tight .
- Semi Lugged or Full Flanged / lugged.
- Patent "U" Seal.
- No Cavity where impurities can gather.
- 2 Piece body design for easy maintenance.
- Adjustment gland and scrapers
- Full cover shroud for protection .
- Limit switch fixing points and a guide slide for inductive switches .
- Manual
- ISO mount Pad
- Pneumatically Actuated
- Electrically Actuated
- V port for flow control
- Key Cap
- Chain wheel
- Rising Stem
- Non Rising Stem
- Quick action lever

- Also available as internally rubber lined.

Applications

- ⇒ Sewage
- ⇒ Water
- ⇒ Sludge
- ⇒ Powders
- ⇒ Abattoirs
- ⇒ Mining



Model XDV-11

50mm– 600mm

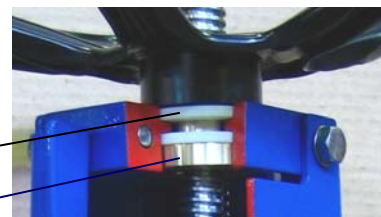
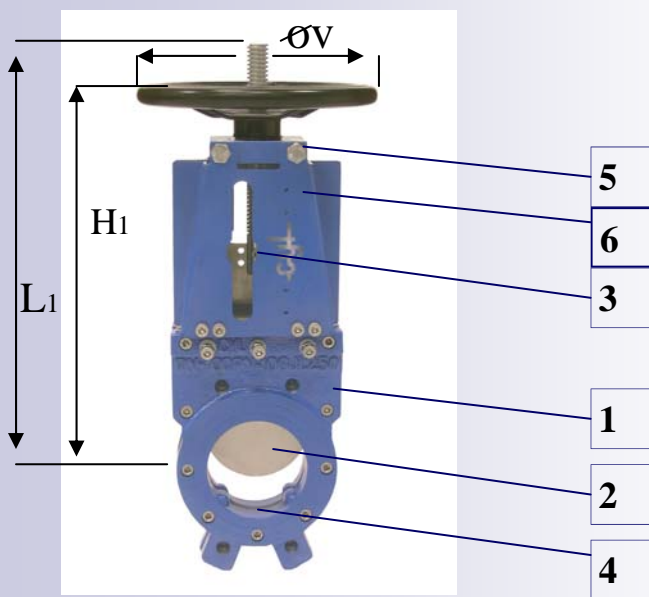

9

7

8

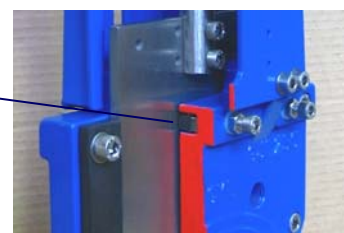

No	Part	Standard Material
1	Body	GG25 EPOXY COATED
2	Blade	AISI 316
3	Spindle	AISI 316
4	Seat	NBR -EPDM -PTFE
5	Fasteners	AISI 316
6	Shroud	Steel Epoxy Coated
7	Stem nut	Bronze
8	Packing seal Backing rod	NBR ANSI 316
9	Washer	Nylon

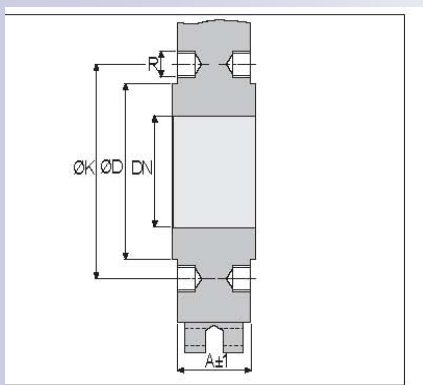

PLEASE NOTE THE XD KNIFE GATE CAN BE MANUFACTURED IN A RANG OF MATERIALS INCLUDING, DUCTILE IRON CF8M, DUPLEX, BRONZE, CARBON STEEL AND ALUMINIUM.

DN	50	65	80	100	125	150	200	250	300	350	400	450	500	600
$A \pm 1$	43	43	50	50	50	60	60	70	80	80	90	90	95	105
H_1	259	285	316	357	391	493	592	692	817	912	1023	1152	1240	1428
K	114	127	146	178	210	235	292	356	438	470	521	584	641	756
D	100	120	135	158	188	212	268	320	370	430	482	532	585	685
R	M-16	M-16	M-16	M-16	M-16	M-16	M-16	M-19	M-19	M-22	M-22	M-22	M-22	M-25
L_1	291	357	385	467	533	634	785	933	1102	1261	1427	1572	1758	2045
$\varnothing V$	175	175	225	225	225	300	300	300	400	400	400	500	500	500
PN Bar	10	10	10	10	10	10	8	8	6	6	5	5	5	4
Weight kg	7	8	11	13	15	24	35	55	67	120	135	205	225	300

Model XDV-11



XD Knife Gate Seat and Seal Advantages

The XD knife gate valve has a patent “U” seal and split body arrangement. Solid shroud protection from spindle. Seal adjusters and provision for scrapers.

Minimal clearance between the valve body and the blade, eliminates any product depositing.

“U” seal is Vulcanized rubber with a metallic soul.

The absence of a cavity at the sealing point stops solids gathering and eliminates the need for a deflection cone.

Bi-directional flow, Zero leakage

Each valve is tested to 1.5 times its working pressure.

Full flow No Cavity where impurities can gather.

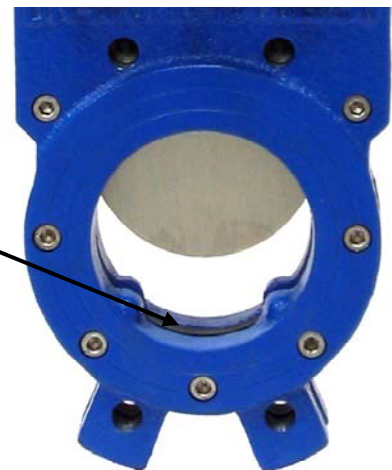
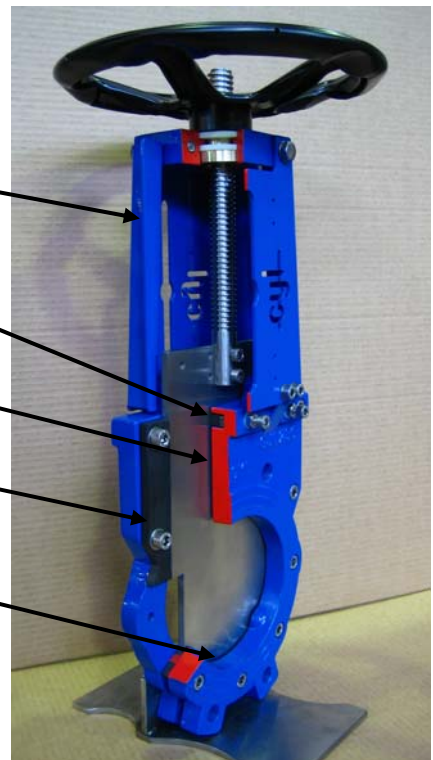

Please contact AVFI for further technical information

AVFI RESERVES THE RIGHT TO CHANGE PRODUCT DESIGN AND SPECIFICATION WITHOUT PRIOR NOTICE.

Australian Valve & Filter Industries P/L

ABN: 75 071 024 925

website: www.avfi.com.au

email: avfi@avfi.com.au

248 Wolseley Place | Thomastown Vic 3074 | Australia

Ph: 03 9460 5444 | Fax: 03 9460 5510

AVFI CYL KNIFE GATE TORQUE CHART

VALVE	WP standard	MIN.TORQUE	MAX.TORQUE	Nº TURNS	THREAD
50	10	8 Nm	16 Nm	14	18 x 4
65	10	10 Nm	17 Nm	17	18 x 4
80	10	12 Nm	19 Nm	21	20 x 4
100	10	15 Nm	22 Nm	26	20 x 4
125	10	17 Nm	24 Nm	33	20 x 4
150	10	25 Nm	50 Nm	31	24 x 5
200	8	27 Nm	53 Nm	41	24 x 5
250	8	50 Nm	69 Nm	51	24 x 5
300	6	63 Nm	84 Nm	61	28 x 5
350	6	78 Nm	102 Nm	71	28 x 5
400	5	90 Nm	110 Nm	81	28 x 5
450	5	215 Nm	259 Nm	65	40 x 7
500	5	223 Nm	388 Nm	72	40 x 7
600	4	249 Nm	320 Nm	86	40 x 7
700	3	330 Nm	436 Nm	89	50 x 8
800	2	420 Nm	570 Nm	102	50 x 8
900	1,5	512 Nm	783 Nm	114	50 x 8
1000	1	620 Nm	987 Nm	113	60 x 9
1200	1	950 Nm	1460 Nm	136	60 x 9

TORQUE CALCULATED WITHOUT GEAR BOX.

For Further Information Please Contact

AUSTRALIAN VALVE & FILTER INDUSTRIES PTY LTD

www.avfi.com.au

Ph: 03 9460 5444

